

END STAGE

Seating Capacity

234 + 2 Ushers

Performance Space

Approx 128m²

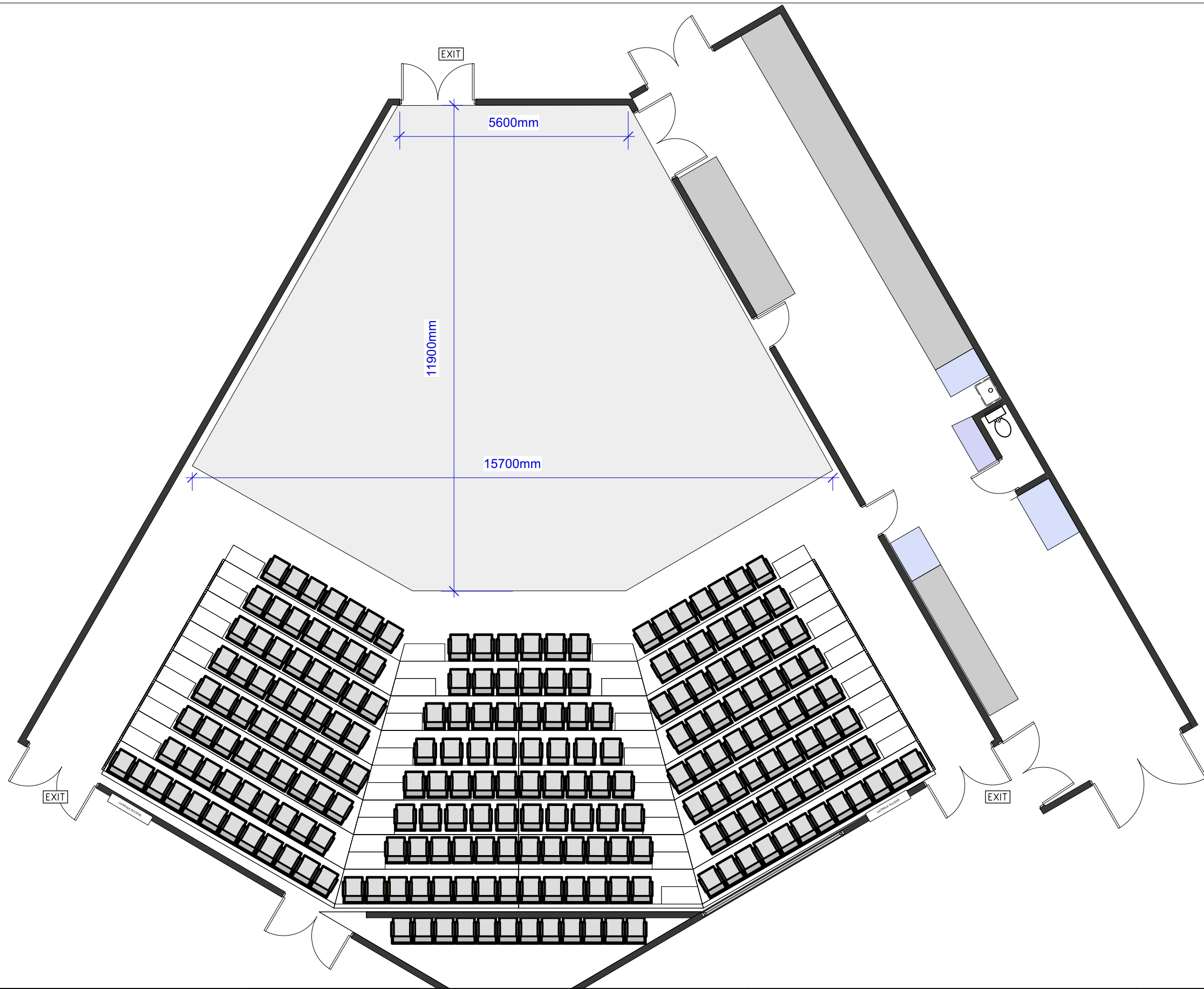

ISSUES		COMMISSIONED BY		SHEET NAME		PROJECT		PAGE	
A	2/03/23	Initial Drawing Presentation	WS	Seating - End Stage				2	
B	15/03/23	Updated BOH space.	WS	SCALE 1:100 ISO A3		DRAWING DATE 17 Nov 2023		of 9	
<p>This design and associated paperwork remain the intellectual property of the designer named within. This documentation and designs held within must not be reproduced, distributed or copied without the express written permission from the named designer.</p> <p>Tungsten Projects Limited are not certified in structural design. All designs are for artistic purposes and the installer is responsible for ensuring the structural validity and any relevant sign-off.</p> <p>PO BOX 14140 KILBIRNIE WELLINGTON 6241 - INFO@TUNGSTENPROJECTS.CO.NZ - WWW.TUNGSTENPROJECTS.CO.NZ</p>				DESIGNER		VENUE		ISSUE	
				DRAWN BY		PROJECT DATE			
				William Smith		Circa One, Circa Theatre			
						19/02/23			

CAD SERVICES

TUNGSTEN PROJECTS

THRUST STAGE

Seating Capacity

222 + 2 Ushers

Performance Space

Approx 28m²

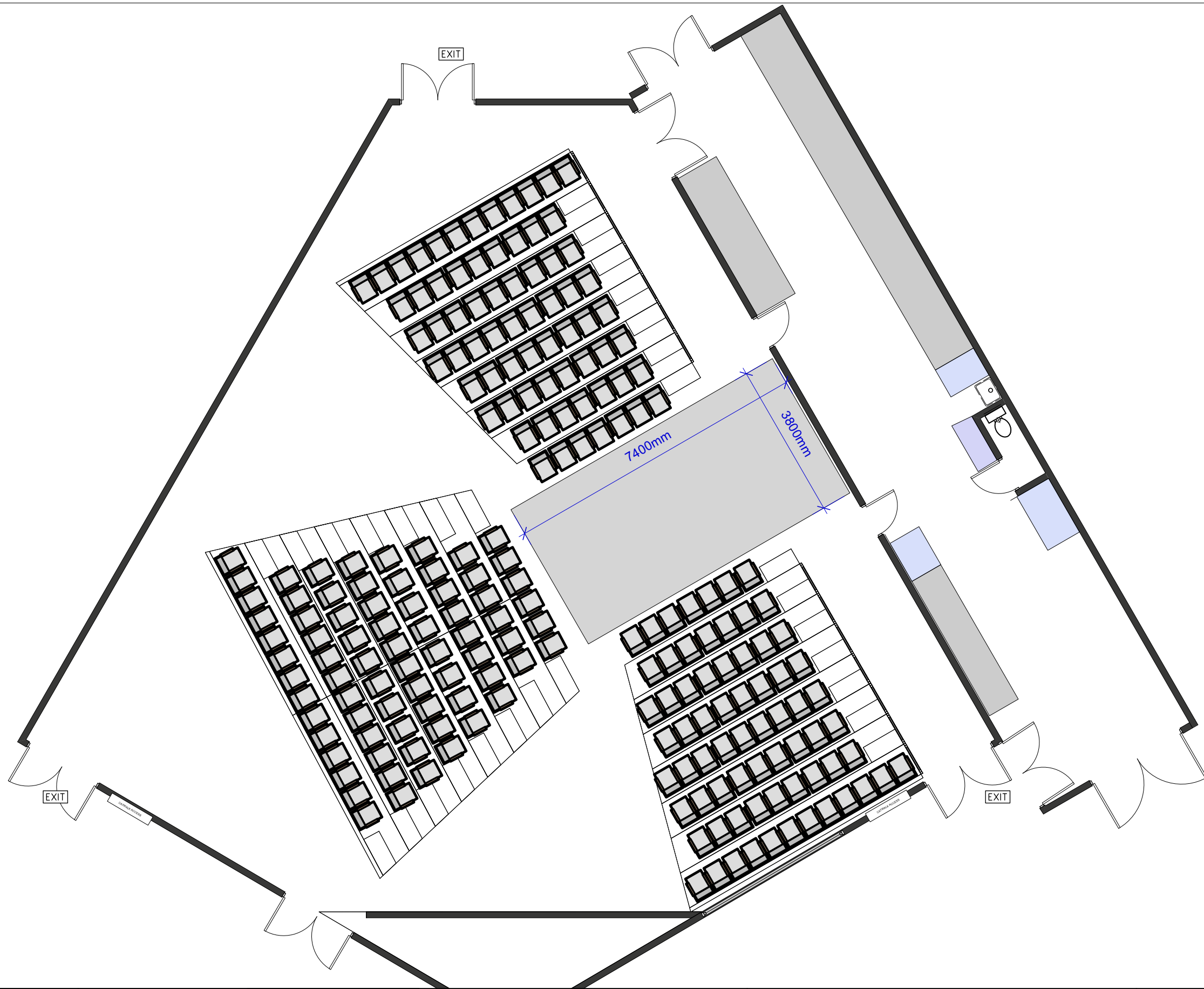

ISSUES		COMISSIONED BY		SHEET NAME		PROJECT		PAGE	
A	2/03/23	Initial Drawing Presentation	WS	Seating - Thrust				3	
B	15/03/23	Updated BOH space.	WS	SCALE 1:100 ISO A3		DRAWING DATE 17 Nov 2023		of 9	
<p>This design and associated paperwork remain the intellectual property of the designer named within. This documentation and designs held within must not be reproduced, distributed or copied without the express written permission from the named designer.</p> <p>Tungsten Projects Limited are not certified in structural design. All designs are for artistic purposes and the installer is responsible for ensuring the structural validity and any relevant sign-off.</p> <p>PO BOX 14140 KILBIRNIE WELLINGTON 6241 - INFO@TUNGSTENPROJECTS.CO.NZ - WWW.TUNGSTENPROJECTS.CO.NZ</p>				DESIGNER		VENUE		ISSUE	
				DRAWN BY William Smith		Circa One, Circa Theatre		PROJECT DATE 19/02/23	

CAD SERVICES
TUNGSTEN PROJECTS

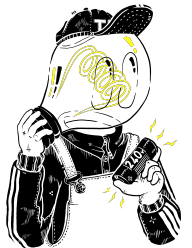

TRAVERSE STAGE

Seating Capacity

222 + 2 Ushers

Performance Space

Approx 38m2

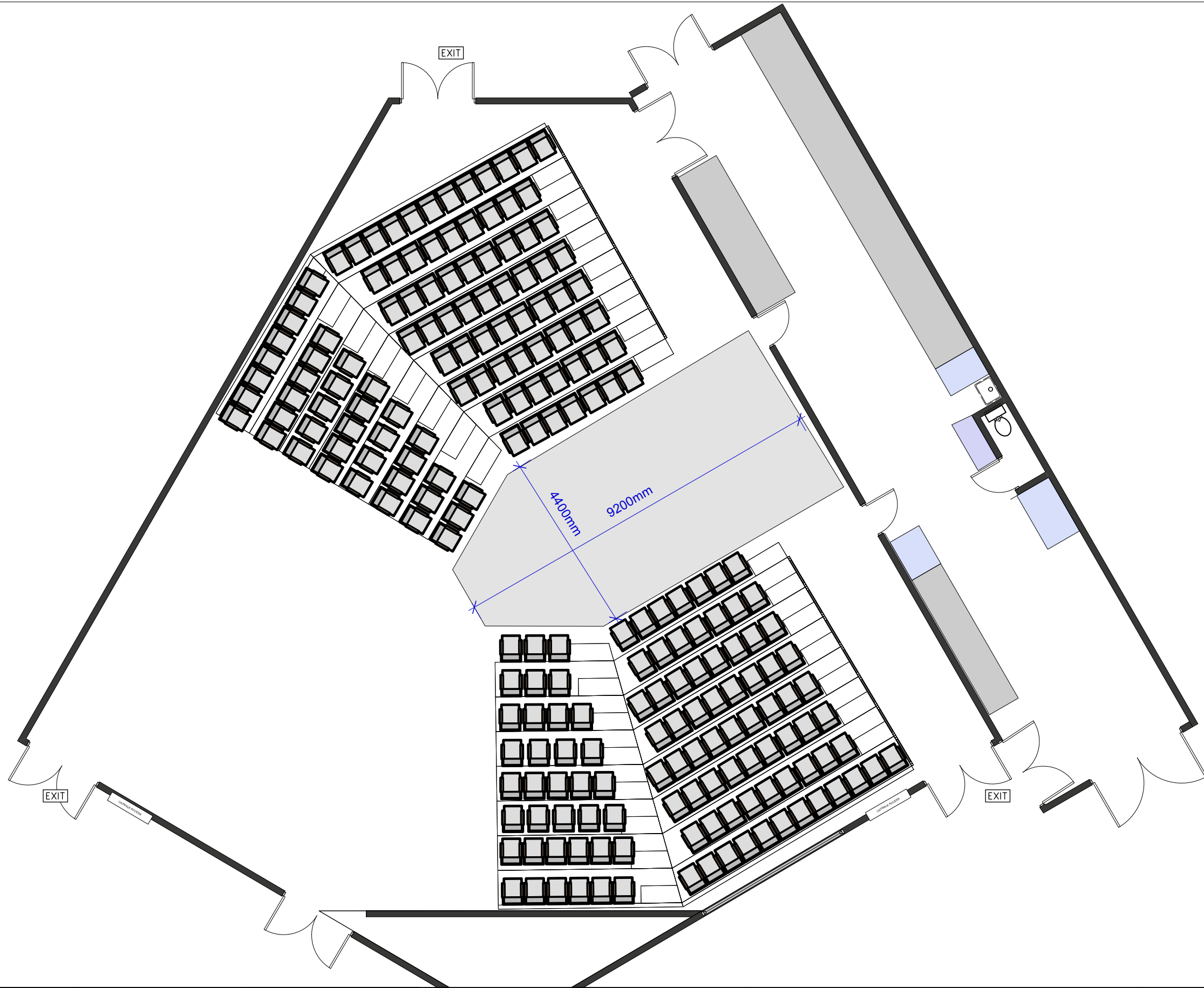

ISSUES		COMMISSIONED BY		SHEET NAME		PROJECT		PAGE	
A	2/03/23	Initial Drawing Presentation	WS	Seating - Traverse				5	
B	15/03/23	Updated BOH space.	WS	SCALE 1:100 ISO A3 DRAWING DATE 17 Nov 2023		PRODUCER		of 9	
<p>This design and associated paperwork remain the intellectual property of the designer named within. This documentation and designs held within must not be reproduced, distributed or copied without the express written permission from the named designer.</p> <p>Tungsten Projects Limited are not certified in structural design. All designs are for artistic purposes and the installer is responsible for ensuring the structural validity and any relevant sign-off.</p> <p>PO BOX 14140 KILBIRNIE WELLINGTON 6241 - INFO@TUNGSTENPROJECTS.CO.NZ - WWW.TUNGSTENPROJECTS.CO.NZ</p>				DESIGNER		VENUE		ISSUE	
				DRAWN BY William Smith		Circa One, Circa Theatre		PROJECT DATE 19/02/23	

SIDE ON

Seating Capacity

186 + 2 Ushers

Performance Space

Approx 117m²

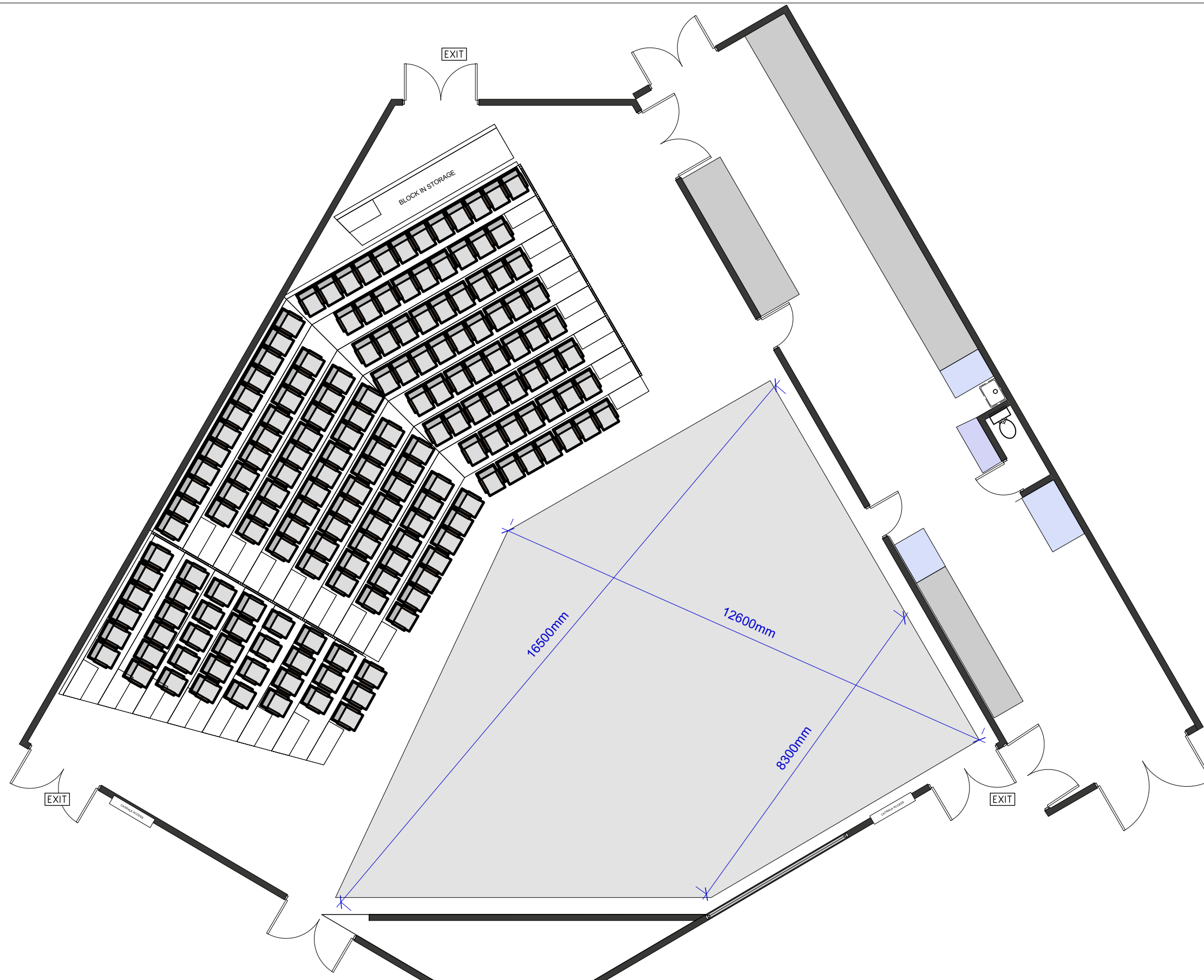

ISSUES		COMMISSIONED BY		SHEET NAME		PROJECT		PAGE	
A	2/03/23	Initial Drawing Presentation	WS	Seating - Side				4	
B	15/03/23	Updated BOH space.	WS	SCALE 1:100 ISO A3		DRAWING DATE 17 Nov 2023		of 9	
<p>This design and associated paperwork remain the intellectual property of the designer named within. This documentation and designs held within must not be reproduced, distributed or copied without the express written permission from the named designer.</p> <p>Tungsten Projects Limited are not certified in structural design. All designs are for artistic purposes and the installer is responsible for ensuring the structural validity and any relevant sign-off.</p> <p>PO BOX 14140 KILBIRNIE WELLINGTON 6241 - INFO@TUNGSTENPROJECTS.CO.NZ - WWW.TUNGSTENPROJECTS.CO.NZ</p>				DESIGNER		VENUE		ISSUE	
				DRAWN BY William Smith		Circa One, Circa Theatre		PROJECT DATE 19/02/23	